

BLA Series

● 105°C 5,000Hrs assured

- Vertical SMD type
- Long life of BDA Series.
- For LCD MT, AVN
- Ecological capacitors are also available.

Solvent-
proof



BDA



BLA

Long life

SPECIFICATIONS

Item	Characteristics							
Rated Voltage Range	4 ~ 50V _{DC}							
Operating Temperature Range	-40 ~ + 105°C							
Capacitance Tolerance	±20% (M) (at 20°C, 120Hz)							
Leakage Current	I = 0.01CV(μA) or 3μA, whichever is greater Where, I : Leakage current(μA), C : Nominal capacitance(μF), V: Rated voltage(V _{DC}) (at 20°C, 2 minutes)							
Dissipation Factor Tanδ(Max.)	Rated Voltage(V _{DC})	4	6.3	10	16	25	35	50
	Tanδ(Max.)	0.37	0.28	0.24	0.20	0.16	0.13	0.12
(at 20°C, 120Hz)								
Temperature Characteristics (Max. Impedance ratio)	Rated Voltage(V _{DC})	4	6.3	10	16	25~50		
	Z(-25°C)/Z(20°C)	8	4	3	2	2		
	Z(-40°C)/Z(20°C)	14	10	7	5	3		
(at 120Hz)								
Load Life	The following specifications shall be satisfied when the capacitors are restored to 20°C after the rated voltage applied for 5,000 hours. 105°C. Capacitance change ≤ ±30% of the initial value Tanδ ≤ 300% of the initial specified value Leakage current ≤ The initial specified value							
Shelf Life	The following specifications shall be satisfied when the capacitors are restored to 20°C after exposing them 1,000hours at 105°C without voltage applied. The rated voltage shall be applied to the capacitors for a Minimum of 30 minutes, at least 24 hours and not more than 48 hours before the measurements. Capacitance change ≤ ±30% of the initial value Tanδ ≤ 300% of the initial specified value Leakage current ≤ The initial specified value							
Others	Satisfied characteristics W of KS C 6421							

PART NUMBERING SYSTEM

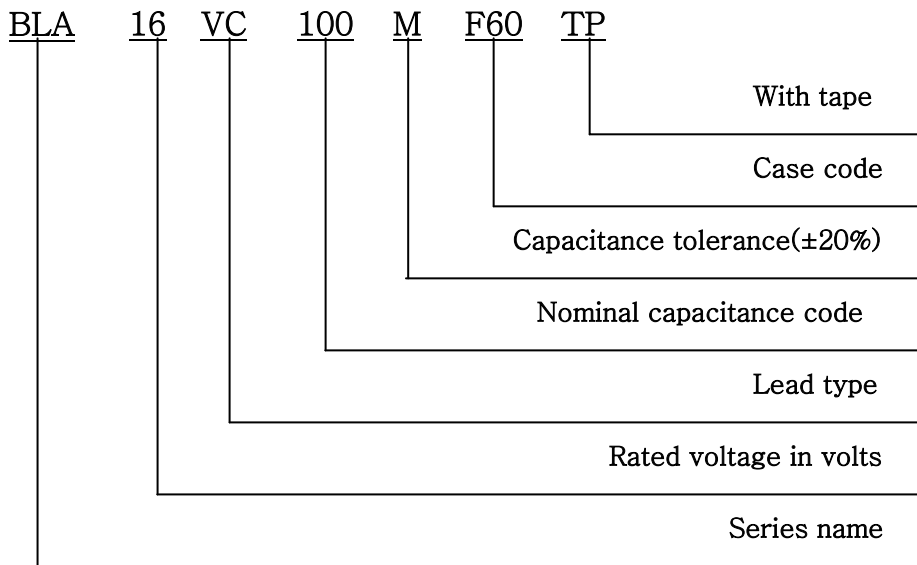

Capacitance	Code
0.1 μF	R1
0.47 μF	R47
1.0 μF	1
4.7 μF	4R7
10 μF	10
100 μF	100

DIMENSIONS OF BLA Series (Type :VC)

DIMENSIONS

Marking

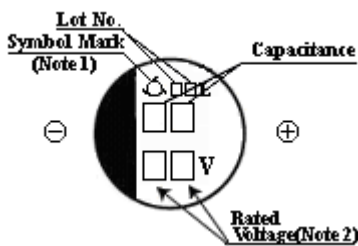

Recommended solder land on PC board

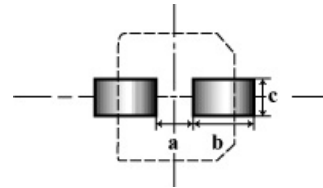

 Sold land on PC board

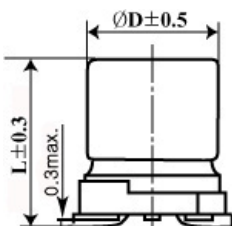

Note 1 : 4 x 5.2(D55), 5 x 5.2(E55) is excluded symbol mark

Note 2 : 6.3WV is marked by 6V.

Note 3 : Case Color ; Clarity Green

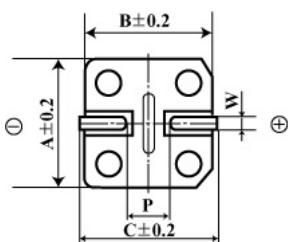

Case code	$\varnothing D$	L	A	B	C	W	P	a	b	c
D55	4	5.2	4.3	4.3	5.1	0.5-0.8	1.0	1.0	2.6	1.6
E55	5	5.2	5.3	5.3	5.9	0.5-0.8	1.4	1.4	3.0	1.6
F55	6.3	5.2	6.6	6.6	7.2	0.5-0.8	1.9	1.9	3.5	1.6
F60	6.3	5.7	6.6	6.6	7.2	0.5-0.8	1.9	1.9	3.5	1.6

RATINGS OF BLA Series

μ	V_{DC}		4(0G)		6.3(0J)		10(1A)		16(1C)		25(1E)		35(1V)	
0.1														
0.22														
0.33														
0.47														
1														
2.2														
3.3														
4.7											D55	13	D55	15
10									D55	16	E55	25	E55	25
22	D55	19	D55	21	E55	30	E55	30	E55	30	F55	40	F55	40
33	E55	30	E55	34	E55	34	F55	45	F55	45				
47	E55	34	E55	36	F55	48	F55	48	F60	52				
100	E55	45	F60	56	F60	90	F60	110						

▲ Permissible Ripple Current(mArms/105°C, 120Hz)

▲ Case Code

μ	V_{DC}		50(1H)	
0.1	D55	1.3		
0.22	D55	2.6		
0.33	D55	3.2		
0.47	D55	3.8		
1	D55	5.6		
2.2	D55	10		
3.3	D55	14		
4.7	E55	19		
10	F55	29		