

CDA Series

● 125°C 1,000~ 2,000Hrs assured

- Vertical SMD type
- Wide Temperature range
- For ECU, ESA
- Ecological capacitors are also available.

Solvent-
proof



MVK

CDA

Wide Temp

SPECIFICATIONS

Item	Characteristics									
Rated Voltage Range	6.3 ~ 80 V _{DC}									
Operating Temperature Range	-40 ~ +125°C									
Capacitance Tolerance	±20% (M) (at 20°C, 120Hz)									
Leakage Current	I = 0.01CV(μA) or 3μA, whichever is greater Where, I : Max. Leakage current(μA), C : Nominal capacitance(μF), V: Rated voltage(V _{DC}) (at 20°C, 2 minutes)									
Dissipation Factor Tanδ(Max.)	Rated Voltage(V _{DC})	6.3	10	16	25	35	50	63	80	
	Tanδ(Max.)	0.28	0.24	0.20	0.16	0.14	0.16	0.18	0.18	(at 20°C, 120Hz)
Temperature Characteristics (Max. Impedance ratio)	Rated Voltage(V _{DC})	6.3	10	16	25	35~80				
	Z(-25°C) / Z(+20°C)	6	4	3	2	2				
	Z(-40°C) / Z(+20°C)	12	10	8	6	4				
	(at 120Hz)									
Load Life	The following specifications shall be satisfied when the capacitors are restored to 20°C after the rated voltage applied with the following conditions. Ø 4~ Ø 6.3 : 125°C, 1,000hours. Ø 8 & Ø 12.5 : 125°C, 2,000hours Capacitance change ≤± 30% of the initial value Tanδ ≤ 300% of the initial specified value Leakage current ≤ The initial specified value									
Shelf Life	The following specifications shall be satisfied when the capacitors are restored to 20°C after exposing them for 1000 hours at 125°C without voltage applied. The rated voltage shall be applied to the capacitors for a minimum of 30 minutes, at least 24 hours and not more than 48 hours before the measurements. Ø 4~ Ø 6.3 : 125°C, 500hours. Ø 8 & Ø 12.5 : 125°C, 1,000hours Capacitance change ≤± 30% of the initial value Tanδ ≤ 300% of the initial specified value Leakage current ≤ The initial specified value									
Others	Satisfied characteristics W of KS C 6421									

PART NUMBERING SYSTEM

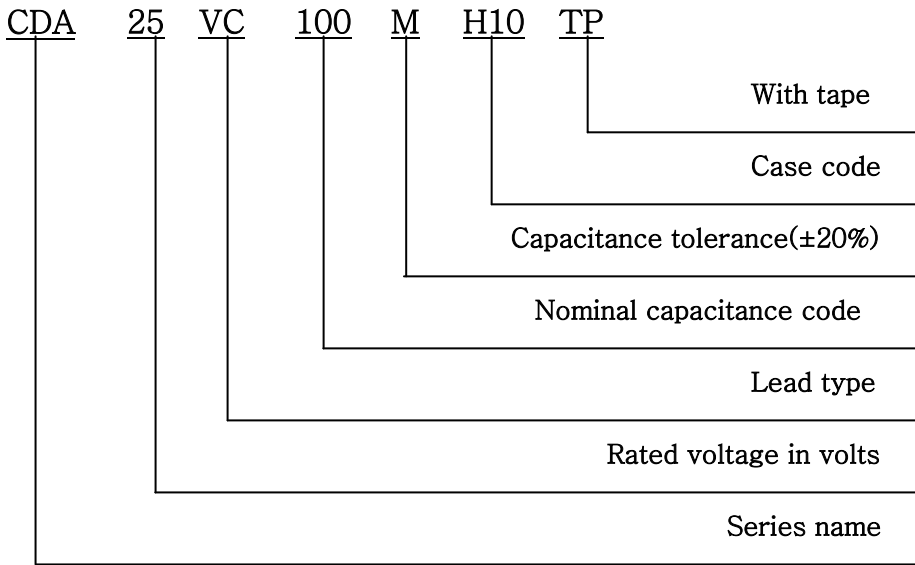

Capacitance	Code
0.1 μF	R1
0.47 μF	R47
1.0 μF	1
4.7 μF	4R7
10 μF	10
100 μF	100

DIMENSIONS OF CDA Series (Type :VC)

DIMENSIONS

Marking

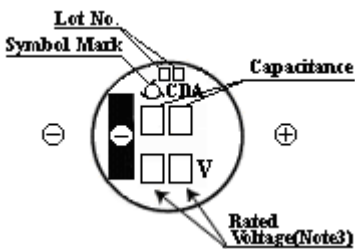
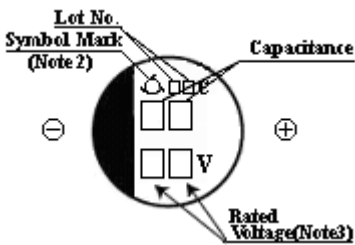

Recommended solder land on PC board

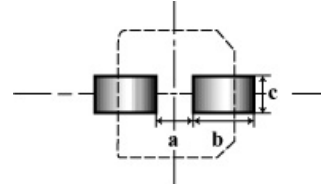

 **Sold land on PC board**

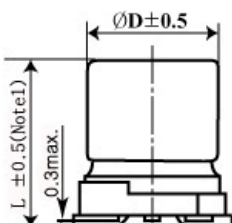

Note 1 : $L + 0.3$ for 6.3 x 5.7 (F60)

Note 2 : Case Color ; Clarity Green

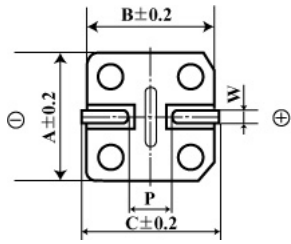

Case code	Ø D	L	A	B	C	W	P	a	b	c
D55	4	5.2	4.3	4.3	5.1	0.5-0.8	1.0	1.0	2.6	1.6
E55	5	5.2	5.3	5.3	5.9	0.5-0.8	1.4	1.4	3.0	1.6
F55	6.3	5.2	6.6	6.6	7.2	0.5-0.8	1.9	1.9	3.5	1.6
F60	6.3	5.7	6.6	6.6	7.2	0.5-0.8	1.9	1.9	3.5	1.6
H63	8	6.3	8.3	8.3	9.0	0.5-0.8	2.3	2.3	4.5	1.6
H10	8	10	8.3	8.3	9.0	0.7-1.1	3.1	3.1	4.2	2.2
J10	10	10	10.3	10.3	11.0	0.7-1.1	4.5	4.5	4.4	2.2
K14	12.5	13.5	13.0	13.0	13.7	1.0-0.3	4.2	4.0	5.7	2.5

RATINGS OF CDA Series

V _{DC} µF	6.3(OJ)		10(1A)		16(1C)		25(1E)	
	4.7							
10					D55	8	E55	13
22	D55	11	E55	15	E55	15	F55	20
33	E55	17	E55	17	F55	22	F60	30
47	E55	19	F55	24	F60	28	F63	45
100	F60	28	H63	48	H63	50	H10	84
220	H63	75	H10	91	H10	100	J10	141
330	H10	100	J10	125	J10	145	K14	380
470	J10	150	J10	150	K14	430		
1,000	K14	480	K14	480				

Case Code ▲

Rated ripple Current (mArms/125°C, 120Hz) ▲

μF \ V _{DC}	35(1V)		50(1H)		63(1J)		80(1K)	
4.7	D55	10	F55	11	F60	15	H63	18
10	F60	18	F60	18	H63	22	H10	25
22	F60	26	H63	28	H10	37	J10	40
33	H63	41	H10	50	J10	58	J10	58
47	H10	61	J10	70	J10	70	K14	180
100	J10	101	K14	250	K14	250		
220	K14	320						