

MVG Series

● 85°C 1,000~2,000Hrs assured

- Vertical SMD type
- Downsized of MV Series
- For CD/DVD-ROM, Navigation, LCD MT/TV
- Ecological capacitors are also available

Solvent-proof

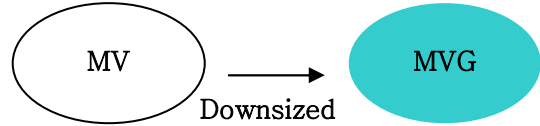

SPECIFICATIONS

Item	Characteristics										
Rated Voltage Range	4~ 450 V _{DC}										
Operating Temperature Range	-40 ~ + 85 °C										
Capacitance Tolerance	±20% (M) (at 20 °C ,120 Hz)										
Leakage Current	Rated Volatag(V _{DC})	4~400					160~450				
	Max. leakage current(μA)	0.01CV (μA) or 3μA, whichever is greater. (at 20°C , 2 minutes)					0.04CV + 100(μA) (at 20°C , 1 minutes)				
Where, C: Nominal capacitance(μF), V: Rated voltage(V _{DC})											
Dissipation Factor (Tanδ)	Rated Volatag(V _{DC})	4	6.3	10	16	25~50	63~100	160~250	400~450		
	Tanδ(Max.)	0.42	0.40	0.30	0.20	0.15	0.12	0.20	0.25		
(at 20 °C, 120Hz)											
Temperature Characteristics (Impedance ratio)	Rated Voltage(V _{DC})	4	6.3	10	16	25	35~50	63~100	160~250	400~450	
	Z (-25°C) / Z (20°C)	7	4	3	2	2	2	3	3	6	
	Z (40°C) / Z (20°C)	15	10	8	6	4	3	4	6	10	
(at 120Hz)											
Load Life	Rated Voltage(V _{DC})	4 ~ 6.3			10 ~ 100			160 ~ 450			
	Capacitance change	≤ ±30% of the initial value			≤ ±25% of the initial value			≤ ±20% of the initial value			
	TAN δ	≤ 300% of the initial specified value					≤ 200% of the initial specified value				
	Leakage Current	≤ The initial specified value									
Shelf Life	Rated Voltage(V _{DC})	4 ~ 6.3			10 ~ 100			160 ~ 450			
	Capacitance change	≤ ±30% of the initial value			≤ ±25% of the initial value			≤ ±20% of the initial value			
	TAN δ	≤ 300% of the initial specified value					≤ 200% of the initial specified value				
	Leakage Current	≤ The initial specified value									
Others	Satisfied characteristics W of KS C 6421										

PART NUMBERING SYSTEM

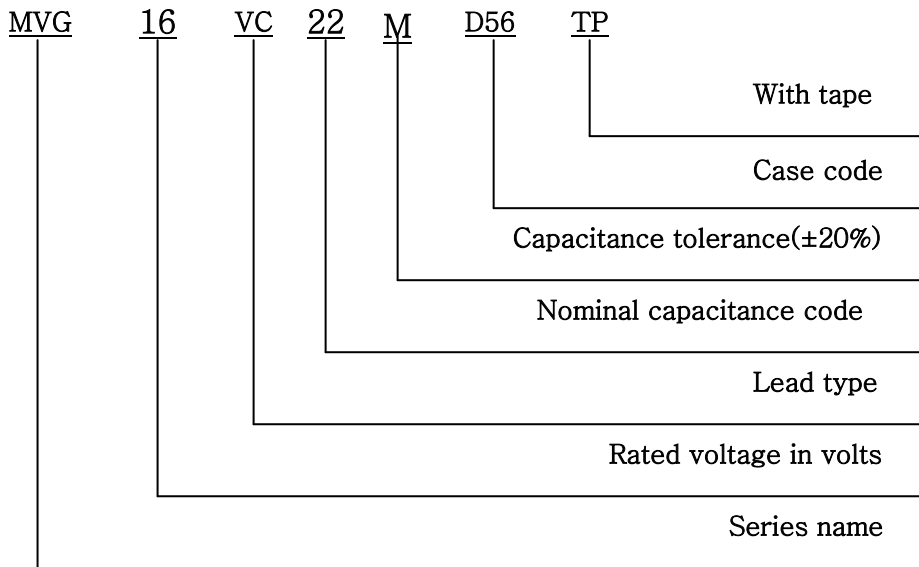

Capacitance	Code
0.1 μF	R1
0.47 μF	R47
1.0 μF	1
4.7 μF	4R7
10 μF	10
100 μF	100

DIMENSIONS OF MVG Series (Type : VC)

Unit(mm)

DIMENSIONS

Recommended solder land on PC board

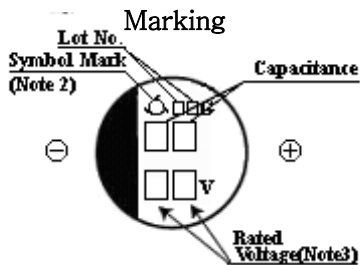

< B55 to J10 >

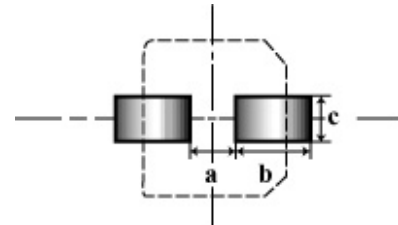

 Sold land on PC board

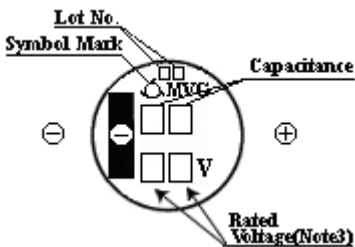

< K14 >

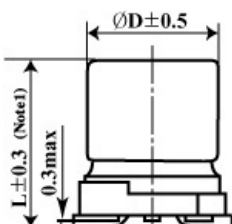

Note 1: $L \pm 0.5$ for 8×6.3(H63), 8×10(H10), 10×10(J10), 12.5×13.5(K14)

Note 2: 3×5.2(B55), 5×5.3(D56) is excluded symbol mark

Note 3: 6.3WV is marked by 6V

Note 4: Case Color ; Clarity Green

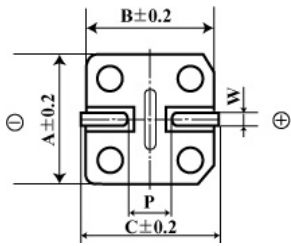

Case code	Ø D	L	A	B	C	W	P	a	b	c
D55	3	5.2	3.3	3.3	3.7	0.45-0.75	0.8	0.8	2.2	1.6
D56	Ø 4	5.3	4.3	4.3	5.1	0.5-0.8	1.0	1.0	2.6	1.6
E56	Ø 5	5.3	5.3	5.3	5.9	0.5-0.8	1.4	1.4	3.0	1.6
F56	Ø 6.3	5.3	6.6	6.6	7.2	0.5-0.8	1.9	1.9	3.5	1.6
F60	Ø 6.3	5.7	6.6	6.6	7.2	0.5-0.8	1.9	1.9	3.5	1.6
F80	Ø 6.3	7.7	6.6	6.6	7.2	0.5-0.8	1.9	1.9	3.5	1.6
H63	Ø 8	6.3	8.3	8.3	9.0	0.5-0.8	2.3	2.3	4.5	1.6
H10	Ø 8	10	8.3	8.3	9.0	0.7-1.1	3.1	3.1	4.2	2.2
J10	10	10	10.3	10.3	11.0	0.7-1.1	4.5	4.5	4.4	2.2
K14	12.5	13.5	13.0	13.0	13.7	1.0-1.3	4.5	4.5	5.7	2.5

RATINGS OF MVG Series

µF \ V _{DC}	4(OG)		6.3(OJ)		10(1A)		16(1C)		25(1E)		35(1V)	
	0.1											
0.22												
0.33												
0.47												
1												
2.2											B55 D56	7.7
3.3											B55 D56	9.4
4.7									B55 D56	10.5	D56	15
10					B55 D56	12.8	B55 D56	14 17	D56	20	D56	25
22	B55 D56	14	D55 D56	23	D56	27	D56	27	E56	28	F56	33
33	D56	23	D56	30	D56	30	E56	40	E56	40	F56	40
47	D56	27	D56	33	E56	45	E56	45	F56	60	F60	55
68	E56	38	E56	49	F56	54	F56	78	F60	90	H63	157
100	E56	46	E56	55	F56	65	F60	85	F80 H63	145	H10	175
220	F56	74	F60	75	F80 H63	130	F80	130	H10	260	H10	260
330			F80 H63	135	H10	270	H10	270	H10	300	J10	360
470			H10	280	H10	280	H10	280				
1,000			J10	430	J10	430	K14	710	K14	820		
1,500			J10	480	K14	850						
2,200			K14	890	K14	960						

Case Code ↑
 Rated ripple Current (mArms/85°C, 120Hz) ↑

μF	V_{DC}		50(1H)		63(1J)		100(2A)	
	0.1	B55 D56	1.1 1.3	D56	1.3			
0.22	B55 D56	2.0 2.9	D56	3.0				
0.33	B55 D56	3.0 3.5	D56	4.0				
0.47	B55 D56	3.8 4.2	D56	5.0				
1	B55 D56	5.6 6.2	D56	8.0				
2.2	B55 D56	8.3 10	D56	12				
3.3	D56	14	E56	17				
4.7	D56	19	E56	20				
10	E56	29	F60	32				
22	F60	40	F80	60	H10	90		
33	F80	55	H10	110	J10	120		
47	H63	140	H10	130	K14	250		
68	H10	170	J10	170	K14	380		
100	H10	190	K14	380	K14	440		
220	J10	320	K14	580				
330	K14	600						

μF	V_{DC}		160(2C)		200(2D)		250(2E)		400(2G)		450(2W)	
	4.7									K14	120	K14
10	J10	55	K14	150	K14	150						
22	K14	240	K14	240								
33	K14	260										

Rated ripple Current (mArms/85°C, 120Hz)
 Case Code

* Height 4.6mm Max. is available request.

Please check with us about individual size and dimensions.